

T.I. No.: 2020 - 23 Updated: -	Topic: Barista Software Version 2.3.1
--	--

Date: 03.12.2020	Priority	Need for action
Affected machines: Barista	High	As soon as possible
From serial number: -	X Medium	X On next visit to the machine
As of date: immediately	Low	FYI

IMPROVEMENTS

New Features

- CM-Remote (advance implementation)
- AutoSteam pre-selection at machines with two AutoSteams

Optimisations

- General performance and process stability
- Adjustment of the initial opening of the proportional valve at beverage start
- Adjustments at machines with two AutoSteams
- Display of portafilter removal optimised
- Pressure reduction routine steam boiler / flow heater
- Serial accounting – optimisation of credit enquiry „All free of charge“

ADVICE FOR TECHNICIANS

The new software has been put to the test in the course of extensive internal approval tests. However, if errors should occur after the software update, we ask you for a data back-up to the USB stick, copy this data in an e-mail and send it to the e-mail address at Schaerer together with an exact error description.

Update power stage version:

During the power stage update, it may happen that the display remains in the beans picture for about 15 seconds before the machine restarts automatically.

If the error 9883 is shown during the update, then the power stage version has not yet been transferred. In this case the firmware update of the power stage must be mandatorily performed manually.

Menu Service > Service routines > Firmware update power stage

NEW FEATURES

CM-Remote (advance implementation)

The setting "CM-Remote" has been added to the "Machine configuration" menu. However, this function is not yet fully available and is currently only used by a few major customers.

Also in the service menu under "Authorisations" there is the setting "Network". At present, this "Network" function cannot be used.

As soon as these functions are completely implemented in the software, we will inform you in detail.

The function "Schaerer-SmartRemote" known from other Schaerer machines is not implemented in the Schaerer Barista. espresso.

AutoSteam pre-selection at machines with two AutoSteams

On machines with two AutoSteams, the new software allows the "AutoSteam pre-selection" function to be activated in the "Operating options".

If "AutoSteam pre-selection" is activated, while an AutoSteam dispensing is running on one side, the next AutoSteam output can be completely prepared on the other side and the dispensing start can be marked with an AutoSteam button. The marked AutoSteam dispensing then starts automatically after the running AutoSteam output is finished.

If the AutoSteam pre-selection is active, this is shown in the display - see indication.

System > Operating options > AutoSteam pre-selection



The function AutoSteam pre-selection can be used together with the function „Milk foam selection“.

General performance and process stability

With the NGx3 Telemetry protocol activated, it was found that the machine could respond with a delay to pressing a hot water button or opening the rotary wheel for BasicSteam output.

Similarly, even without the NGx3 Telemetry protocol activated, there could be a delay in response for various applications/processes.

With the new software, the process sequences were optimised and thus the performance and process stability were significantly increased.

Adjustment of the initial opening of the proportional valve at beverage start

It was found that on machines with an increased water inlet temperature in connection with several coffee dispensings in a row, the beverage dispensing at the portafilter spout could boil over and thus the beverage quality and dispensing temperature could not be maintained.

The reason for this was an insufficiently designed initial opening (valve start opening) of the proportional valve, which determined the cold water addition for the first 2 seconds of beverage dispensing.

With this software version, the initial opening of the proportional valve was increased by 20%. In internal tests, after implementation of this measure and correctly adjusted "cold water mixing calibration", an overboiling during beverage dispensing could not be provoked anymore.

It is to be expected that after an update to this software version, the beverage temperatures will slightly change.

Therefore, we recommend carrying out a mixing calibration for both brewing groups after the software update.

Service > Service routines > Mixing calibration > Mixing calibration left/right

Adjustments at machines with two AutoSteams

Previously, on machines with two AutoSteams, parallel dispensing of AutoSteam on the right and hot water was not possible.

Also, the function "milk foam selection" in the display could only be programmed for 3 milk foam recipes.

With the new software, hot water and AutoSteam on the right can now be dispensed parallelly and up to 6 recipes can be programmed for milk foam selection.

Display of portafilter removal optimised

After the introduction of the feature "Display portafilter removal" we were informed that when the function is activated, it sometimes happened that although the portafilter was removed, emptied and inserted again, the green indicator "Remove portafilter now" remained on the display.

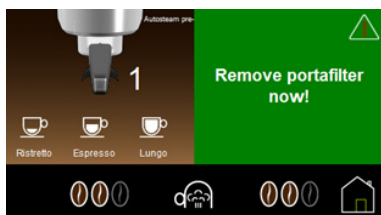

It was also reported that in case of a beans empty message the display changed from the red "Do not remove portafilter!" display to the regular "brown" background colour.

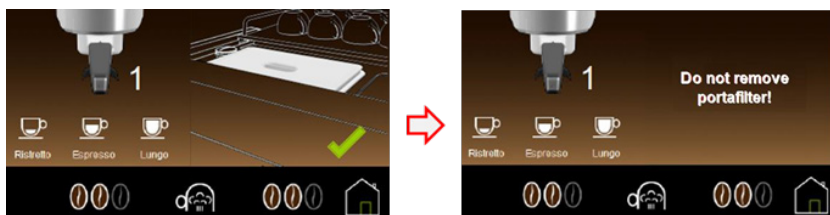

Both display errors have been corrected with the new software version.

Pressure reduction routine steam boiler / flow heater

With the changed pressure reduction routine, after the pressure in the steam boiler / flow heater has been reduced and the prompt "Close water supply!" has been confirmed, the two brewing valves are opened again in order to release any residual pressure.

Service > Service routines > Pressure reduction steam boiler

Serial accounting – optimisation of credit enquiry "All free of charge"

If the coffee machine is set to "All free of charge", no more credit enquiries are sent to the POS system/SmartSchank and any remaining credits in the POS system are not deleted.

