

T.I. no.: 2020 - 08 Updated: -	Topic: Temperature sensor spare parts
---	--

Date: 30.03.2020	Priority	Need for action
Affected machines: SCP	High	As soon as possible
From serial number: Backwards compatible	Medium	On next visit to the machine
As of date: March 2020	X Low	X FYI only

BOTH TEMPERATURE SENSORS ARE NOW AVAILABLE AS SPARE PARTS

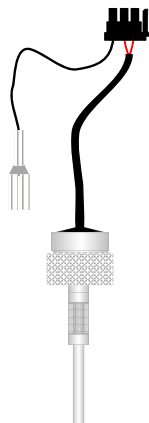

TEMPERATURE SENSOR FOR STEAM BOILER (075'249)



TEMPERATURE SENSOR FOR HOT WATER BOILER (075'248)

REPLACING TEMPERATURE SENSOR

Materials and tools



HEAT-CONDUCTING PASTE
(067'391)



5.5MM DRILL OR SCREWDRIVER

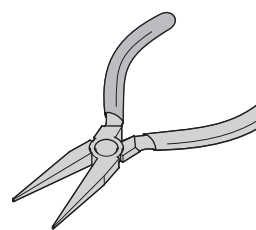

LONG-NOSE PLIERS

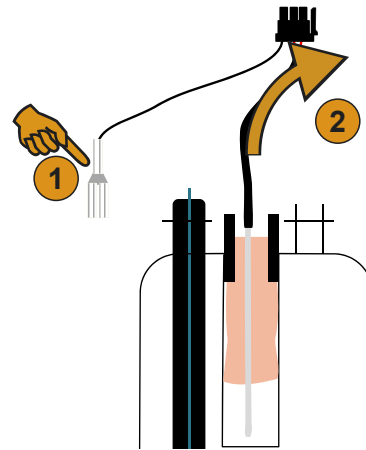
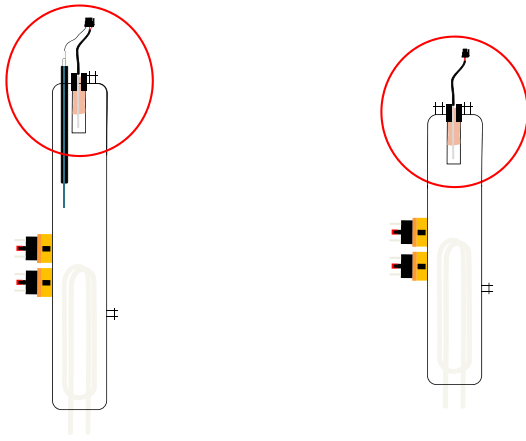

1. REMOVE LEVEL SENSOR PLUG
2. PULL OUT TEMPERATURE SENSOR

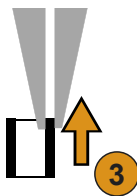

3. REMOVE BLACK SEALING RING

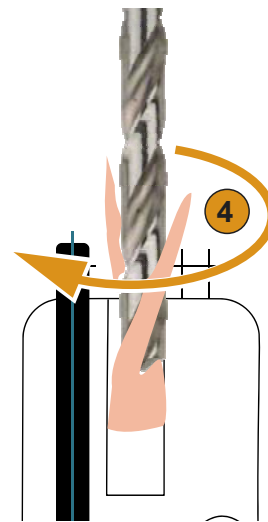
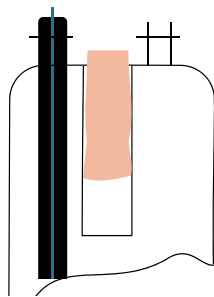

4. REMOVE SEALING COMPOUND

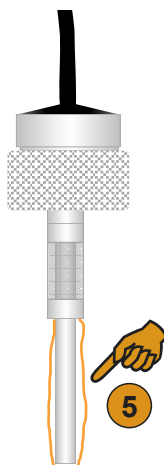

5. APPLY HEAT-CONDUCTING PASTE

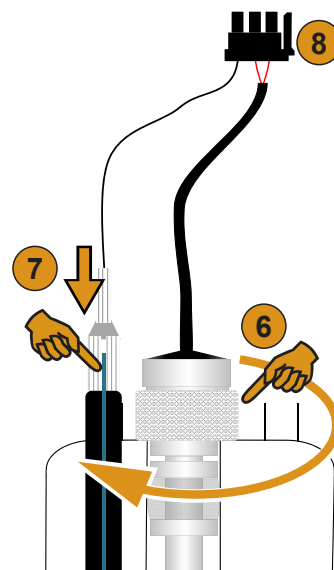

6. INSERT AND TIGHTEN TEMPERATURE SENSOR
7. CONNECT LEVEL SENSOR PLUG
8. CONNECT TEMPERATURE SENSOR TO ELECTRICAL SUPPLY