

T.I. no.: 2018 - 01 Updated: -	Topic: SCA P BF Software 1.71
--	--------------------------------------

Date: 29.01.2018	Priority	Need for action
Affected machines: SCA P BF	High	As soon as possible
From serial number: 1802../	X Medium	X On next visit to the machine
As of date: -	Low	FYI only

NEW FUNCTIONS AND IMPROVEMENTS

The following is an overview of the new functions and fixed errors:

New functions:

- Thai characters can be displayed on the TouchIT.
- If the machine needs longer than 3 seconds to prepare a cold or hot beverage, a message is displayed.
- Most current version of M2M integrated.
- Recipe ID for MDB payment systems integrated.
- Telemetry integrated via MDB Comms gateway.
- Parallel dispensing of milk via the beverage outlet and coffee via the swan neck.
- Error messages such as "Grounds container empty", "Grinder empty", etc. are also displayed for test beverages.
- Switch-on rinsing with activated milk system only performed when milk is detected.
- The brewing time display is activated in the Quick menu. The brewing time is displayed after beverage dispensing.

Improvements

- Various text adaptations.
- New logo integrated.
- All consumers (air pump, steam valve, etc) are deactivated when the grounds drawer is pulled.
- Mandatory cleaning is only triggered when a beverage has been dispensed since the last cleaning.
- The "Touch screen cleaning" function works correctly.
- The "Safety switches" parameter in the "System parameters" menu has been omitted.
- Flush coffee is dispensed properly.
- Pre-brewing works correctly and is performed directly before brewing.
- If cleaning is done on a machine with CM, milk rinsing cannot be performed on the second machine.
- Activated MDB interface without existing payment system no longer causes the machine to block when starting.
- Malfunction in machines with card reader and coin tester when using a card and cash at the same time fixed.
- The "Coffee spirits" beverage can also be dispensed without an activated milk system.
- If the Flavour Point in the Service menu is deactivated, all associated parameters are deactivated.
- Faulty switch-off when timer is used has been fixed.
- Instruction to deactivate the milk system during Flavour Point cleaning no longer appears.
- When cleaning the Flavour Point, the pumps now run for 3 x 70 seconds and no longer for 3 x 20 seconds.
- Service menu button is displayed correctly.
- Card credit of 0.00 is displayed correctly.
- More than two token channels are supported.
- If the complete remaining amount cannot be dispensed because there is not enough money, a message is output. The beverages which can be dispensed with the remaining amount are then available.
- Sales statistics can be read out with the programming card even with an MDB payment system.
- Time delay of the beverage button release when using a card reader and DIVA reduced.
- "Free" is no longer displayed for the beverage price when the accounting is deactivated or the price is set to 0.00.
- Beverages which have the price 0.00 are correctly detected (DIVA).
- MDB level 3 is no longer set to level 2 after a rinsing.
- If beverages are programmed on the external buttons, beverage page 4 is erroneously displayed. This has been fixed.

- Double dispensing is correctly billed.
- The "Power supply USA/CAN" parameter is now always correctly displayed.
- Unnecessary output variants removed, e.g. "Portion control" for coffee beverages.
- Error messages are also correctly displayed after a restart.
- "Standby" field is no longer active when the "On/Off with Chef card" parameter is active.
- The brewing time is correctly detected by the telemetry when the beverage is cancelled.
- "Erase card" works correctly.
- The "Barista" preselection is reset after 5 seconds.
- When the "Barista Silber" design is active without a preselection, a message appears during beverage supply.
- Position of the brewing unit corrected. More ground coffee can now be accepted.

Display of the brewing time

The display for the brewing time can be activated in the "Quick menu" in Standby mode. When the display is active, the brewing time is displayed after beverage dispensing.

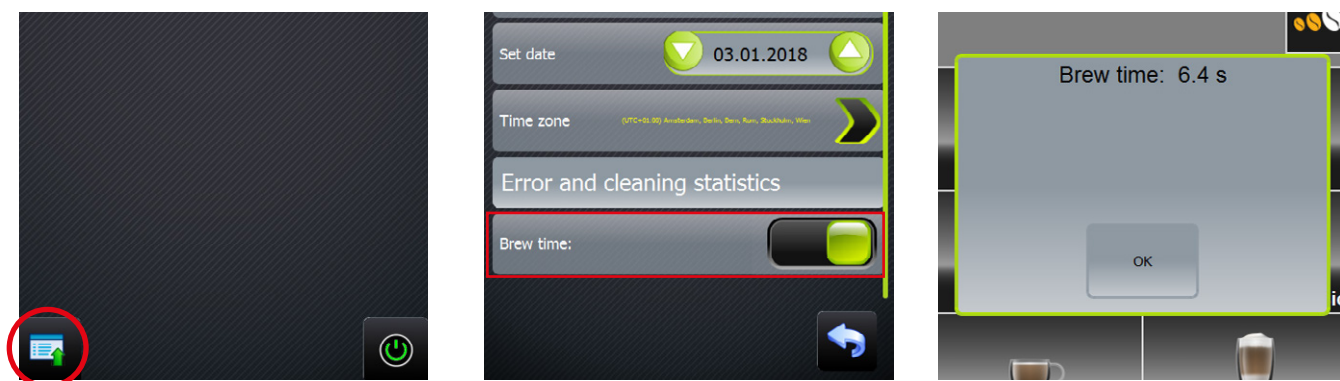

Message for beverage supply when preselection is deactivated

If the preselection is deactivated in the "Barista Silber" design, a message appears during beverage dispensing.

